

i =	3	4	5	7	10
nominal output torque (Nm)	75	100	85	54	40
max. acceleration torque (Nm)	120	130	110	100	75
emergency torque (Nm)	160	216	216	216	160

output shaft bearing: grooved ball bearing 2RS

- max. radial load: 2.400N bei n<sub>2</sub>=100 1/min L<sub>h</sub> > 10.000h
- max. axial load: 1.900N bei n<sub>2</sub>=100 1/min L<sub>h</sub> > 10.000h
- reference to shaft center at temp. = 30°C

straight-toothed planetary gearbox

backlash at output shaft: ≤ 8 arcmin

lifetime: > 30.000h

efficiency: by rated load 94% (depends on ratio)

lubrication: lifetime-lubrication

nominal output torque at n<sub>1</sub> = 3.000 1/min

operating temperature: -20°C bis +90°C

motor mounting: M2 (stocked driving pinion)

- torque of clamping screw: 10Nm

operation mode: S1

operation ratio: cB1

protection system: IP54

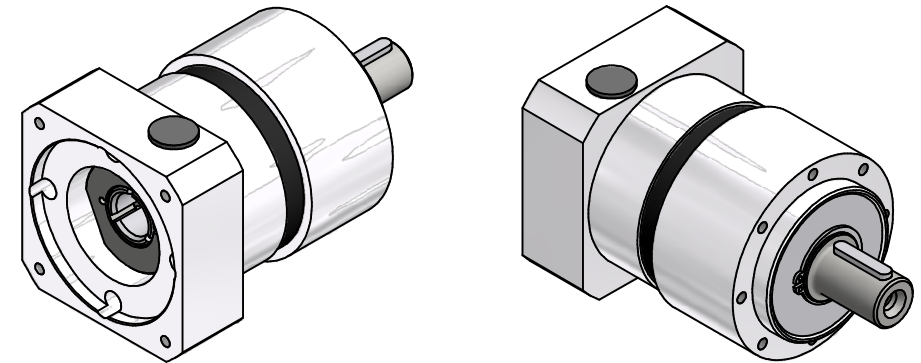

consider mounting instruction  
subject to modifications

Allgemein-toleranzen ISO 2768-mK		Kanten ISO 13715	Maßstab 1:1 [Gewicht]	Generisch	
Verwendungsbereich		Datum 06.05.2020	Name Kanz	EPL90X/1	
		Bearb. 13.05.2020	Name Kanz		
		Freig.			
		Kd-Fr.			
				EISELE	
				400803100-1-E19-K-M475	
				Blatt 2 / 2	
				A2	
Zust.	Änderungen	Datum	Name	Ursprung	