

i =	12	16	20	25	35	40	50	70	100
nominal output torque (Nm)	500	500	500	460	460	500	460	340	190
max. acceleration torque (Nm)	500	500	500	460	460	500	460	460	340
emergency torque (Nm)	860	1000	1000	1000	1000	1000	1000	1000	800

output shaft bearing: grooved ball bearing 2RS

- max. radial load: 7.500N bei n<sub>2</sub>=100 1/min L<sub>h</sub> > 10.000h
- max. axial load: 6.000N bei n<sub>2</sub>=100 1/min L<sub>h</sub> > 10.000h
- reference to shaft center at temp. = 30°C

straight-toothed planetary gearbox

backlash at output shaft: ≤ 10 arcmin

lifetime: > 30.000h

efficiency: by rated load 92% (depends on ratio)

lubrication: lifetime-lubrication

nominal output torque at n<sub>1</sub> = 3.000 1/min

operating temperature: -20°C bis +90°C

motor mounting: M2 (stocked driving pinion)

- torque of clamping screw: 37Nm

operation mode: S1

operation ratio: cB1

protection system: IP54

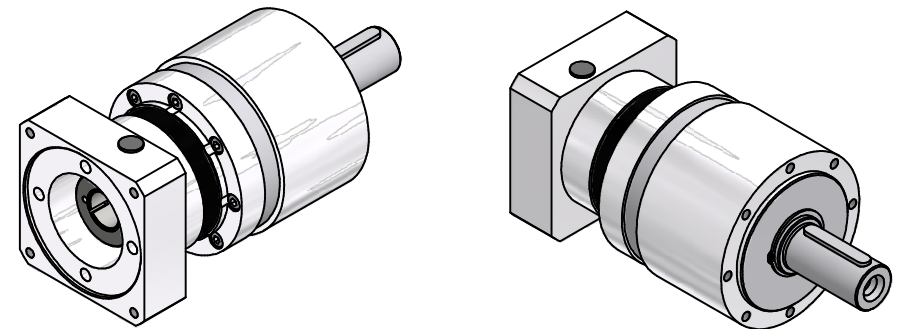

consider mounting instruction  
subject to modifications

Allgemein- toleranzen ISO 2768-mK		Kanten ISO 13715	Maßstab 1 : 2	(Gewicht)
Verwendungsbereich		Datum	Name	Werkstoff, Halbzeug Rohteil-Nr. Generisch
		Erst	Kanz	EPL155X/2
		Bearb.	Kanz	
		Freig.		
		Kd-Fr.		
		EISELE		401503100-2-E32-K-M479
Zust.	Änderungen	Datum	Name	Ursprung
				Blatt 2 / 2 A2