

i =	3	4	5	7	10
nominal output torque (Nm)	405	480	440	310	180
max. acceleration torque (Nm)	490	500	460	460	340
emergency torque (Nm)	860	1000	1000	1000	800

output shaft bearing: grooved ball bearing 2RS

- max. radial load: 7.500N bei n2=100 1/min Lh > 10.000h
- max. axial load: 6.000N bei n2=100 1/min Lh > 10.000h
- reference to shaft center at temp. = 30°C

straight-toothed planetary gearbox

backlash at output shaft: ≤ 7 arcmin

lifetime: > 30.000h

efficiency: by rated load 94% (depends on ratio)

lubrication: lifetime-lubrication

nominal output torque at n1 = 3.000 1/min

operating temperature: -20°C bis +90°C

motor mounting: M2 (stocked driving pinion)

- torque of clamping screw: 37Nm

operation mode: S1

operation ratio: cB1

protection system: IP54

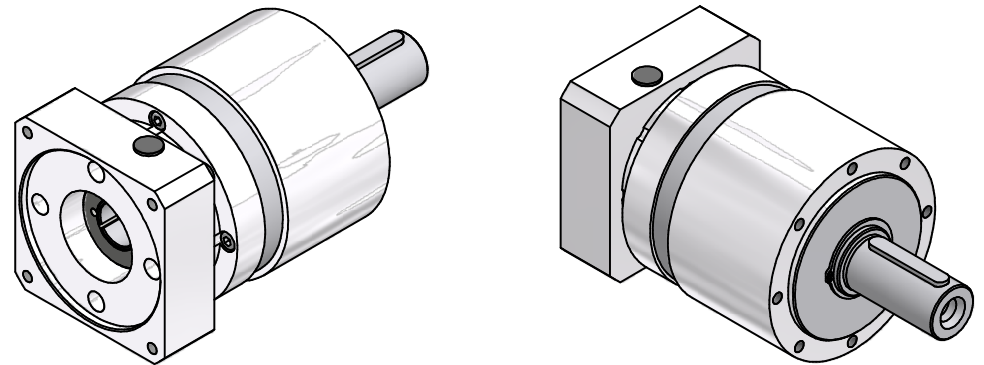

consider mounting instruction  
subject to modifications

Allgemein- toleranzen ISO 2768-mK		Kanten ISO 13715	Maßstab 1 : 2	(Gewicht)
Verwendungsbereich		Datum 19.05.2020	Name Kanz	Werkstoff, Halbzeug Generisch
		Erst 25.05.2020	Name Kanz	Rohteil-Nr. EPL155X/1
		Freig.		Modell-oder Gesenk-Nr.
		Kd-Fr.		
Zust. Änderungen Datum Name Ursprung			EPL155X/1	
			401503100-1-E32-K-M4.04	
			Blatt 2 / 2	
			A2	