

i =	3	4	5	7	10
nominal output torque (Nm)	405	480	440	310	180
max. acceleration torque (Nm)	490	500	460	460	340
emergency torque (Nm)	860	1000	1000	1000	800

output shaft bearing: grooved ball bearing 2RS

- max. radial load: 16.500N bei $n_2=100$ 1/min $L_h > 10.000h$
- max. axial load: 6.100N bei $n_2=100$ 1/min $L_h > 10.000h$
- reference to shaft center at temp. = 30°C

straight-toothed planetary gearbox

backlash at output shaft: ≤ 7 arcmin

lifetime: $> 30.000h$

efficiency: by rated load 94% (depends on ratio)

lubrication: lifetime-lubrication

nominal output torque at $n_1 = 3.000$ 1/min

operating temperature: -20°C bis +90°C

motor mounting: M2 (stocked driving pinion)

- torque of clamping screw: 35Nm

operation mode: S1

operation ratio: cB1

protection system: IP65

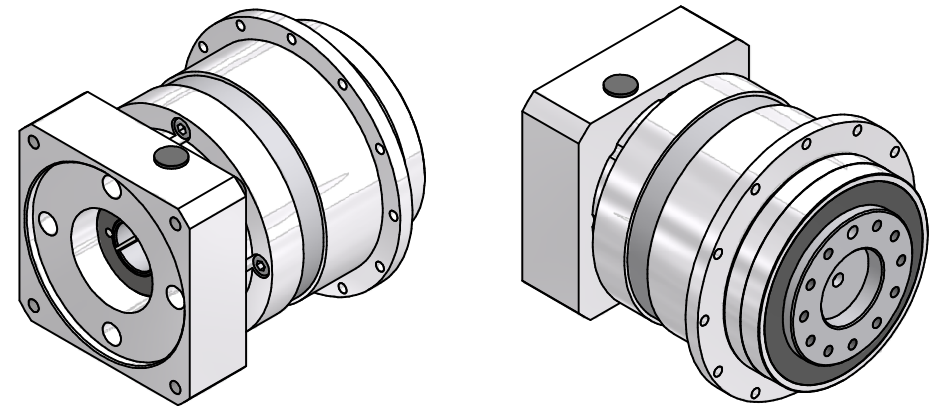

consider mounting instruction
subject to modifications

Verwendungsbereich		Allgemein- toleranzen ISO 2768-mK	Kanten ISO 13715	Maßstab 1 : 2 [Gewicht]
Verwendungsbereich		Datum	Name	EPLFE140/1
		Erst	Kanz	
		Bearb.	Kanz	
		Freig.	Kanz	
		Kd-Fr.		
				40140300-1-E32-K-M404
Zust. Änderungen Datum Name Ursprung				Blatt 2 / 2 A2